

P-2000 FILTER 35-1200 scfm TECHNICAL DATA

TDS-101

MODEL		DIMENSIONS (Inches)							CONNECTIONS (Inches)		APPROX. SHIPPING WEIGHT (lbs)
SU	AF	H		L	W	A	B	C	In/Out (NPT)	Drain (NPT)	
		SU	AF								
P2001-35SU1-G8	P2001-35AF1-G8	14.0	14.6	4.4	5.2	11.0	2.0	3.3	1/2	1/4	6
P2001-60SU1-G12	P2001-60AF1-G12	14.0	14.6	4.4	5.2	11.0	2.0	3.3	3/4	1/4	8
P2001-100SU1-G16	P2001-100AF1-G16	12.5	13.2	5.8	6.6	9.0	2.3	3.6	1	1/4	12
P2001-150SU1-G16	P2001-150AF1-G16	17.3	17.9	5.8	6.6	13.8	2.3	3.6	1-1/4	1/4	14
P2001-275SU1-G24	P2001-275AF1-G24	17.7	17.7	7.0	7.8	12.0	2.8	4.1	1	1/2	18
P2001-400SU1-G32	P2001-400AF1-G32	25.3	25.3	7.0	7.8	19.8	2.8	4.1	2	1/2	24
P2001-600SU1-G40	P2001-600AF1-G40	29.6	29.6	8.1	7.1	22.5	3.8	5.0	2-1/2	1/2	28
P2001-800SU1-G40	P2001-800AF1-G40	34.6	34.6	8.1	7.1	37.5	3.8	5.0	2-1/3	1/2	32
P2001-1000SU1-G48	P2001-1000AF1-G48	39.6	39.6	8.1	7.1	32.5	3.8	5.0	3	1/2	36
P2001-1200SU1-G48	P2001-1200AF1-G48	44.6	44.6	8.1	7.1	37.5	3.8	5.0	3	1/2	39

Note: For disassembly of housing and element replacement, all filters must be installed with sufficient clearance below the lowest portion of any drain valves or piping. Refer to the "A" dimension for the required element changeout clearance.

Materials

COMPONENT	MATERIAL
Vessel head, bowl	Aluminum alloy
Surface finish	Powder coat
O-Rings	Buna N
Support cores	Stainless steel or non-corrosive polymer
SU and AF Element	Microglass fibers and non-woven polyester; glass-filled nylon end caps
Element Adhesive	Two-part epoxy
Manual Drain	Brass
Liquid Presence Indicator	Brass

Maximum operating temperature: 150°F (65°C)
 Maximum recommended filtration temperature: 120°F (49°C)
 Minimum inlet filtration temperature: 34°F (1°C)
 Maximum pressure: 300 psig

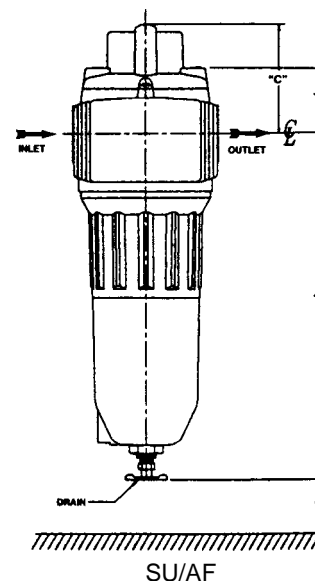
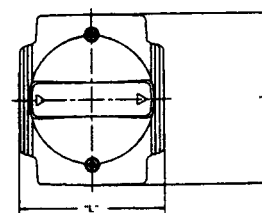

ISO 9001



4647 SW 40th Avenue • Ocala, Florida 34474
 Tel 352-237-5500 • Fax 352-873-5187
 e-mail ppcsale1@udi-flair.com
 www.pneumaticproducts.com

P-2000 FILTER

1600-15000 scfm

TECHNICAL DATA

MODEL		MAXIMUM OPERATING PRESSURE (PSIG)	DIMENSIONS (Inches)						CARTRIDGE QUANTITY	MINIMUM OVERHEAD CLEARANCE (Inches)	CONNECTIONS (Inches)			APPROX. SHIPPING WEIGHT (lbs)
SU	AF		H	A	B	D	F	J			In/Out (Flange)	Drain (NFPT)	RELIEF VALVE	
P2001-1600SU2-G49	P2001-1600AF2-G49	200	75.3	20.0	64.0	12.0	19.0	19.0	2	24	3	3/4	2 NPT	490
P2001-2000SU2-G65	P2001-2000AF2-G65	200	80.3	20.0	69.0	12.0	19.0	19.0	2	24	4	3/4	2 NPT	515
P2001-2400SU2-G65	P2001-2400AF2-G65	200	85.3	20.0	74.0	12.0	19.0	19.0	2	24	4	3/4	2 NPT	525
P2001-3000SU3-G65	P2001-3000AF3-G65	200	84.0	21.0	71.0	13.0	24.0	24.0	3	20	4	3/4	2 NPT	635
P2001-4000SU4-G97	P2001-4000AF4-G97	200	87.2	21.0	73.0	14.0	26.0	26.0	4	20	6	3/4	3 NPT	760
P2001-5000SU5-G97	P2001-5000AF5-G97	200	87.7	21.0	73.6	15.0	26.0	26.0	5	20	6	3/4	3 NPT	860
P2001-6000SU5-G97	P2001-6000AF5-G97	200	92.7	21.0	78.6	15.0	26.0	26.0	5	20	6	3/4	3 NPT	875
P2001-7200SU6-G129	P2001-7200AF6-G129	175	103.9	25.0	83.0	16.0	29.0	29.0	6	18	8	3/4	4 FLG	1050
P2001-8400SU7-G129	P2001-8400AF7-G129	175	103.9	25.0	83.0	16.0	29.0	29.0	7	18	8	3/4	4 FLG	1100
P2001-9600SU8-G129	P2001-9600AF8-G129	150	105.6	25.0	84.0	18.0	26.5	23.3	8	18	8	1	4 FLG	1325
P2001-10800SU9-G129	P2001-10800AF9-G129	150	105.6	25.0	84.0	18.0	26.5	23.3	9	18	8	1	4 FLG	1325
P2001-12000SU10-G129	P2001-12000AF10-G129	150	105.6	25.0	84.0	18.0	26.5	23.3	10	18	8	1	4 FLG	1325
P2001-15000SU13-G161	P2001-15000AF13-G161	150	109.0	25.0	86.0	21.0	33.3	28.8	13	18	10	1	6 FLG	1600

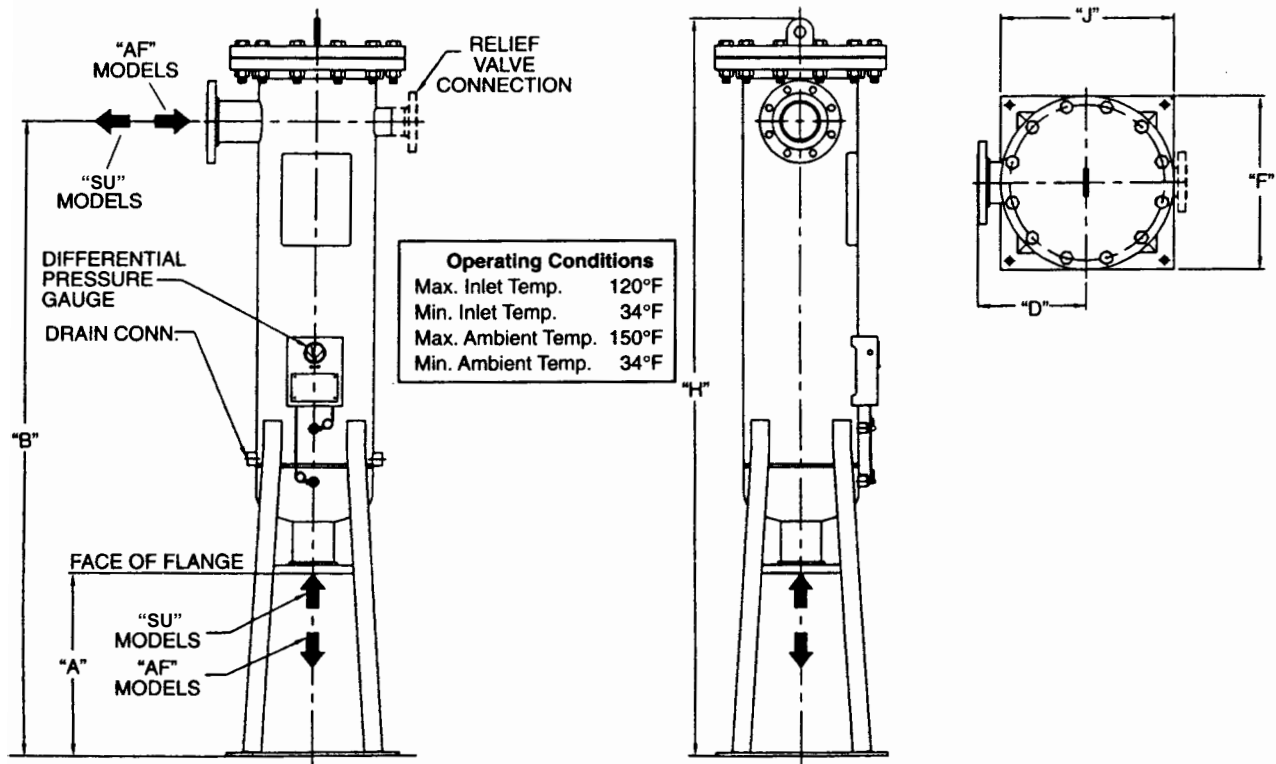

ISO 9001



4647 SW 40th Avenue • Ocala, Florida 34474
 Tel 352-237-5500 • Fax 352-873-5187
 e-mail ppcsale1@udi-flair.com
 www.pneumaticproducts.com

P-2000 FILTER ELEMENT PRESSURE DROP DATA

HEF-SU Dry DP

DRY PRESSURE DROP - PSID at 100°F & 100 PSIG							
MODEL		Flow 10%	Flow 25%	Flow 50%	Flow 75%	Flow 100%	Flow 125%
HEF35SU	Flow	3.5	8.75	17.5	26.25	35	43.75
	PD	0.16	0.25	0.35	0.43	0.50	0.56
HEF60SU	Flow	6	15.	30	45	60	75
	PD	0.21	0.33	0.47	0.57	0.66	0.74
HEF100SU	Flow	10	25.	50	75	100	125
	PD	0.22	0.35	0.49	0.61	0.70	0.78
HEF150SU	Flow	15	37.5	75	112.5	150	187.5
	PD	0.18	0.28	0.40	0.48	0.56	0.63
HEF275SU	Flow	27.5	68.75	137.5	206.25	275	343.75
	PD	0.23	0.37	0.52	0.63	0.73	0.82
HEF400SU	Flow	40	100	200	300	400	500
	PD	0.22	0.35	0.49	0.61	0.70	0.78
HEF600SU	Flow	60	150	300	450	600	750
	PD	0.22	.035	0.49	0.61	0.70	0.78
HEF800SU	Flow	80	200	400	600	800	1000
	PD	0.23	0.37	0.52	0.63	0.73	0.82
HEF1000SU	Flow	100	250	500	750	1000	1250
	PD	0.22	0.35	0.49	0.61	0.70	0.78
HEF1200SU	Flow	120	300	600	900	1200	1500
	PD	0.25	0.40	0.56	0.68	0.79	0.88

HEF-SU Saturated DP

SATURATED PRESSURE DROP - PSID at 100°F & 100 PSIG (20 ppm challenge)							
MODEL		Flow 10%	Flow 25%	Flow 50%	Flow 75%	Flow 100%	Flow 125%
HEF35SU	Flow	3.5	8.75	17.5	26.25	35	43.75
	PD	0.70	1.10	1.56	1.91	2.2	2.46
HEF60SU	Flow	6	15	30	45	60	75
	PD	0.90	1.43	2.02	2.47	2.85	3.19
HEF100SU	Flow	10	25	50	75	100	125
	PD	0.93	1.48	2.09	2.55	2.95	3.30
HEF150SU	Flow	15	37.5	75	112.5	150	187.5
	PD	0.70	1.11	1.57	1.92	2.22	2.48
HEF275SU	Flow	27.5	68.75	137.5	206.25	275	343.75
	PD	0.86	1.36	1.92	2.36	2.72	3.04
HEF400SU	Flow	40	100	200	300	400	500
	PD	0.87	1.38	1.94	2.38	2.75	3.07
HEF600SU	Flow	60	150	300	450	600	750
	PD	1.01	1.60	2.26	2.77	3.2	3.58
HEF800SU	Flow	80	200	400	600	800	1000
	PD	1.08	1.70	2.4	2.94	3.4	3.8
HEF1000SU	Flow	100	250	500	750	1000	1250
	PD	0.98	1.55	2.19	2.68	3.1	3.47
HEF1200SU	Flow	120	300	600	900	1200	1500
	PD	1.11	1.75	2.47	3.03	3.5	3.91



ISO 9001



4647 SW 40th Avenue • Ocala, Florida 34474
 Tel 352-237-5500 • Fax 352-873-5187
 e-mail ppcsale1@udi-flair.com
 www.pneumaticproducts.com

P-2000 FILTER ELEMENT PRESSURE DROP DATA

HEF-AF Dry DP

DRY PRESSURE DROP - PSID at 100°F & 100 PSIG							
MODEL		Flow 10%	Flow 25%	Flow 50%	Flow 75%	Flow 100%	Flow 125%
HEF35AF	Flow	3.5	8.75	17.5	26.25	35	43.75
	PD	0.05	0.09	0.12	0.15	0.17	0.19
HEF60AF	Flow	6	15	30	45	60	75
	PD	0.07	0.11	0.16	0.19	0.22	0.25
HEF100AF	Flow	10	25	50	75	100	125
	PD	0.05	0.09	0.12	0.15	0.17	0.19
HEF150AF	Flow	15	37.5	75	112.5	150	187.5
	PD	0.06	0.10	0.13	0.16	0.19	0.21
HEF275AF	Flow	27.5	68.75	137.5	206.25	275	343.75
	PD	0.07	0.11	0.15	0.18	0.21	0.23
HEF400AF	Flow	40	100	200	300	400	500
	PD	0.10	0.16	0.23	0.28	0.32	0.36
HEF600AF	Flow	60	150	300	450	600	750
	PD	0.12	0.19	0.26	0.32	0.37	0.41
HEF800AF	Flow	80	200	400	600	800	1000
	PD	0.18	0.28	0.40	0.48	0.56	0.63
HEF1000AF	Flow	100	250	500	750	1000	1250
	PD	0.26	0.41	0.57	0.70	0.81	0.91
HEF1200AF	Flow	120	300	600	900	1200	1500
	PD	0.28	0.45	0.63	0.77	0.89	1.00



ISO 9001



4647 SW 40th Avenue • Ocala, Florida 34474
 Tel 352-237-5500 • Fax 352-873-5187
 e-mail ppcsale1@udi-flair.com
 www.pneumaticproducts.com

P-2000 FILTER ELEMENT FLOW CAPACITY BY PRESSURE

		Operating Pressure (psig)										
		30	40	50	60	70	75	80	90	100	110	120
Flow (scfm)	35	14	17	20	23	26	27	29	32	35	38	41
	60	23	29	34	39	44	47	50	55	60	65	70
	100	39	48	56	65	74	78	83	91	100	109	117
	150	58	72	85	98	111	117	124	137	150	163	176
	275	107	131	155	179	203	215	227	251	275	299	323
	400	156	191	226	261	295	313	330	365	400	435	470
	600	234	286	338	391	443	469	495	548	600	652	705
	800	312	382	451	521	591	626	661	730	800	870	939
	1,000	390	477	564	651	738	782	826	913	1,000	1,087	1,174
	1,200	468	572	677	782	886	938	991	1,095	1,200	1,305	1,409
	1,600	624	763	903	1,042	1,182	1,251	1,321	1,461	1,600	1,739	1,879
	2,000	779	954	1,128	1,303	1,477	1,564	1,651	1,826	2,000	2,174	2,349
	2,400	935	1,145	1,354	1,563	1,772	1,877	1,982	2,191	2,400	2,609	2,818
	3,000	1,169	1,431	1,692	1,954	2,215	2,346	2,477	2,738	3,000	3,262	3,523
	4,000	1,559	1,908	2,256	2,605	2,954	3,128	3,303	3,651	4,000	4,349	4,697
5,000	1,949	2,384	2,820	3,256	3,692	3,910	4,128	4,564	5,000	5,436	5,872	
6,000	2,338	2,861	3,384	3,908	4,431	4,692	4,954	5,477	6,000	6,523	7,046	
7,200	2,806	3,434	4,061	4,689	5,317	5,631	5,945	6,572	7,200	7,828	8,455	
8,400	3,274	4,006	4,738	5,471	6,203	6,569	6,935	7,668	8,400	9,132	9,865	
9,600	3,741	4,578	5,415	6,252	7,089	7,508	7,926	8,763	9,600	10,437	11,274	
10,800	4,209	5,150	6,092	7,034	7,975	8,446	8,917	9,858	10,800	11,742	12,683	
12,000	4,677	5,723	6,769	7,815	8,861	9,384	9,908	10,954	12,000	13,046	14,092	
15,000	5,846	7,153	8,461	9,769	11,077	11,731	12,384	13,692	15,000	16,308	17,616	

		Operating Pressure (psig)										
		125	130	140	150	175	200	225	250	275	300	
Flow (scfm)	35	43	44	47	50	54	57	61	64	67	69	
	60	73	76	81	86	92	98	104	109	114	119	
	100	122	126	135	144	154	164	173	182	190	198	
	150	183	189	202	215	231	246	260	273	286	298	
	275	335	347	371	395	424	451	476	501	524	546	
	400	487	505	539	574	617	656	693	728	762	793	
	600	731	757	809	862	925	984	1,039	1,092	1,143	1,190	
	800	974	1,009	1,079	1,149	1,233	1,312	1,386	1,457	1,524	1,587	
	1,000	1,218	1,262	1,349	1,436	1,541	1,640	1,732	1,821	1,904	1,984	
	1,200	1,462	1,514	1,618	1,723	1,850	1,968	2,079	2,185	2,285	2,380	
	1,600	1,949	2,018	2,158	2,297	2,466	2,624	CONSULT FACTORY				
	2,000	2,436	2,523	2,697	2,872	3,083	3,279					
	2,400	2,923	3,028	3,237	3,446	3,699	3,935					
	3,000	3,654	3,785	4,046	4,308	4,624	4,919					
	4,000	4,872	5,046	5,395	5,744	6,166	6,559					
5,000	6,090	6,308	6,744	7,180	7,707	8,199						
6,000	7,308	7,569	8,092	8,616	9,248	9,838						
7,200	8,769	9,083	9,711	10,339	11,098							
8,400	10,231	10,597	11,329	12,062	12,948							
9,600	11,692	12,111	12,948	13,785								
10,800	13,154	13,625	14,566	15,508								
12,000	14,616	15,139	16,185	17,231								
15,000	18,269	18,923	20,231	21,539								



ISO 9001



4647 SW 40th Avenue • Ocala, Florida 34474
 Tel 352-237-5500 • Fax 352-873-5187
 e-mail ppcsale1@udi-flair.com
 www.pneumaticproducts.com

Improvements and research are continuous at Flair. Some Specifications in this bulletin may change without prior notice. TDS-101, August 2000.